

## Fuel Delivery, Return and Evaporation Lines

FUEL INJECTION (FUEL SYSTEMS)

### 35. Fuel Delivery, Return and Evaporation Lines

#### A: REMOVAL

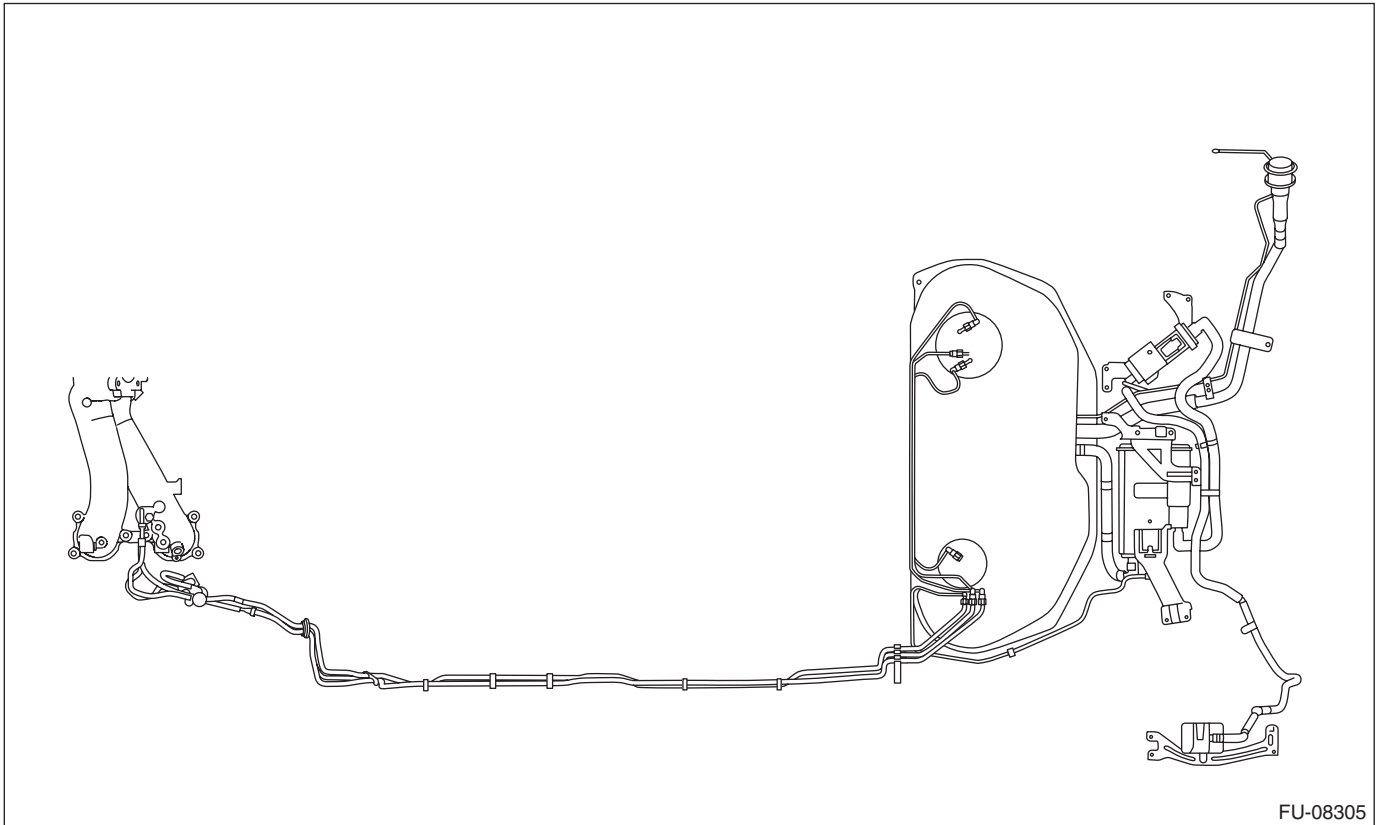

**WARNING:**

Place “NO OPEN FLAMES” signs near the working area.

**CAUTION:**

**Be careful not to spill fuel.**

- 1) Release the fuel pressure. <Ref. to FU(STI)-64, RELEASING OF FUEL PRESSURE, PROCEDURE, Fuel.>
- 2) Open the fuel filler lid and remove the fuel filler cap.

**NOTE:**

This operation is required to release the inner pressure of the fuel tank.

- 3) Remove the floor mat. <Ref. to EI-105, REMOVAL, Floor Mat.>

# Fuel Delivery, Return and Evaporation Lines

FUEL INJECTION (FUEL SYSTEMS)

4) In the engine compartment, disconnect the fuel delivery hoses, fuel return hoses and evaporation hoses.

## CAUTION:

- Be careful not to spill fuel.
- Catch the fuel from hoses using a container or cloth.

(1) Set the ST to the fuel pipe.

ST 42099AE000 QUICK CONNECTOR RELEASE

(2) Disconnect the quick connector of the fuel delivery hose and fuel return hose by pushing the ST in the direction of the arrow.

(3) Remove the clip and disconnect the evaporation hose from the fuel pipe.

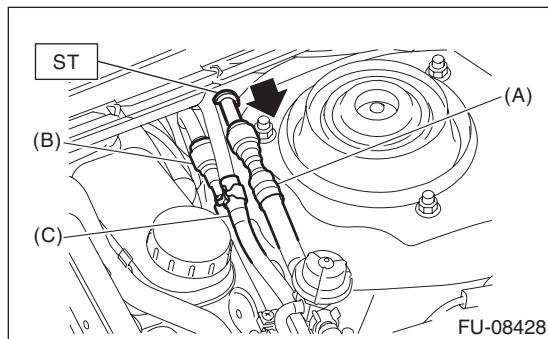

- (A) Fuel delivery hose
- (B) Fuel return hose
- (C) Evaporation hose

5) Remove the fuel tank. <Ref. to FU(STI)-67, REMOVAL, Fuel Tank.>

6) Disconnect the quick connector, and remove the fuel delivery tube, fuel return tube, and jet pump tube from the fuel tank.

- When using ST

1. Attach ST to the pipe and push ST in the direction of arrow mark to disconnect the quick connector.

ST 42099AE000 QUICK CONNECTOR RELEASE

## CAUTION:

- Be careful not to spill fuel.
- Catch the fuel from the tubes using a container or cloth.
- To disconnect the connector, hold (C) shown in the figure and pull in axial direction.
- If the connector and pipe are sticking to each other, push and pull the connector with ST pushed, and then pull the connector after it starts moving freely.
- When disconnecting the connector, do not bend or twist the tube forcibly. If the tube is bent, replace with a new part.

## NOTE:

Clean the pipe and quick connector, if they are covered with dust.

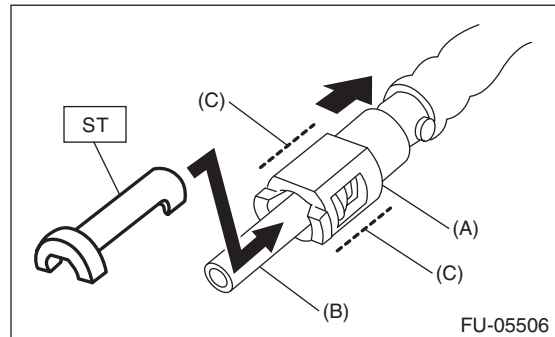

- (A) Quick connector
- (B) Pipe
- (C) Connector holding position

2. To prevent from damaging or entering foreign matter, wrap the pipes and quick connectors with plastic bag etc.

## CAUTION:

When reusing the retainer, do not disconnect the retainer from the connector.

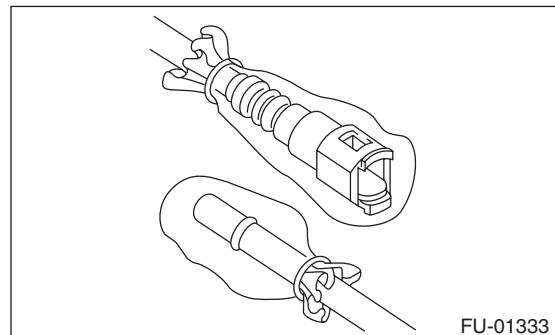

# Fuel Delivery, Return and Evaporation Lines

## FUEL INJECTION (FUEL SYSTEMS)

- When not using ST

1. Push the retainer in the direction of the arrow, disconnect the quick connector from pipe.

### CAUTION:

- Be careful not to spill fuel.
- Catch the fuel from the tubes using a container or cloth.
- To disconnect the connector, hold (D) shown in the figure and pull in axial direction.
- If the connector and pipe are sticking to each other, push and pull the connector with the retainer pushed in the direction of the arrow, and then pull the connector after it starts moving freely.
- When disconnecting the connector, do not bend or twist the tube forcibly. If the tube is bent, replace with a new part.

### NOTE:

Clean the pipe and quick connector, if they are covered with dust.

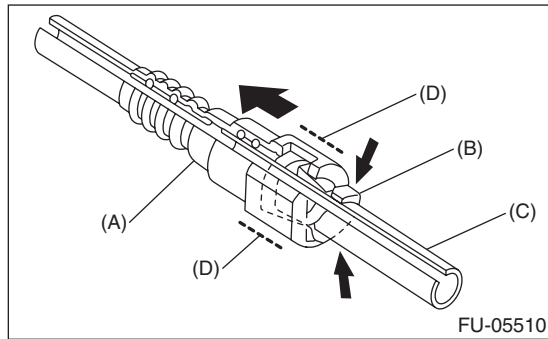

- (A) Quick connector  
(B) Retainer  
(C) Pipe  
(D) Connector holding position

2. To prevent from damaging or entering foreign matter, wrap the pipes and quick connectors with plastic bag etc.

### CAUTION:

**When reusing the retainer, do not disconnect the retainer from the pipe.**

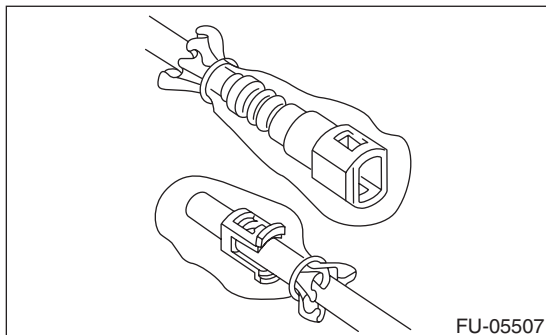

7) Disconnect the quick connector and remove the purge pipe.

### NOTE:

Disconnect the quick connector as shown in the figure.

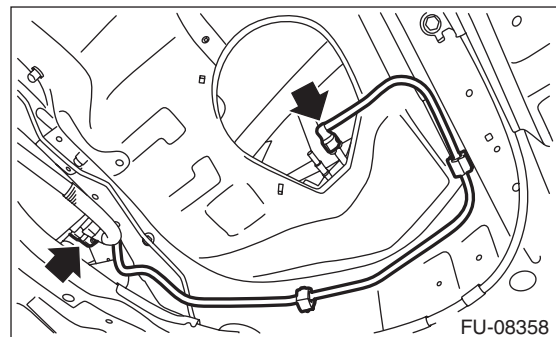
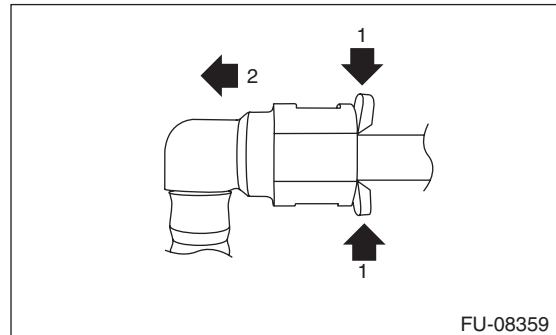

8) Remove the body integrated unit.

- (1) Remove the knee airbag module. <Ref. to AB-35, REMOVAL, Knee Airbag Module.>  
(2) Release the lock and remove the fuse holder from the relay & fuse box.

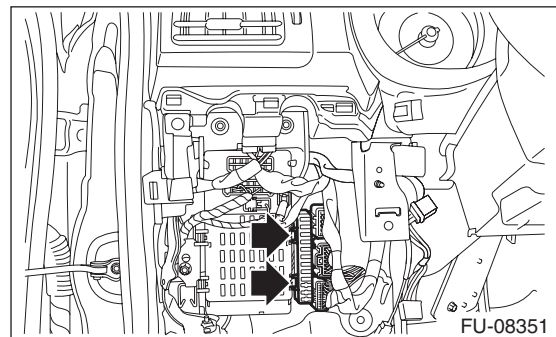

(3) Disconnect the connectors from the relay & fuse box.

- (4) Remove the bolts (A) and nuts (B), and remove the relay & fuse box.

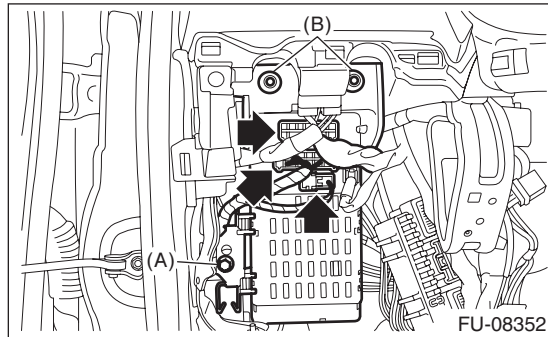

- (5) Release the lock and remove the relay block.

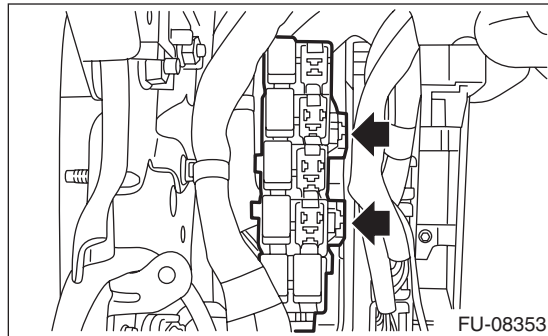

- (6) Disconnect the connector from body integrated unit.

- (7) Remove the bolt (A) and nut (B), and remove the body integrated unit along with the bracket.

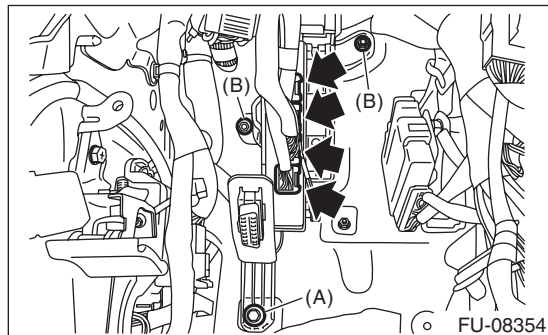

- 9) Remove the fuel pipe assembly from vehicle.

## B: INSTALLATION

Install in the reverse order of removal while being careful of the following.

### 1. CONNECTING THE EVAPORATION LINE QUICK CONNECTOR

#### NOTE:

Connect the quick connector as shown in the figure.

#### CAUTION:

- Check that there is no damage or dust on the quick connector. If necessary, clean the seal surface of the pipe.
- Make sure that the quick connector is securely connected.

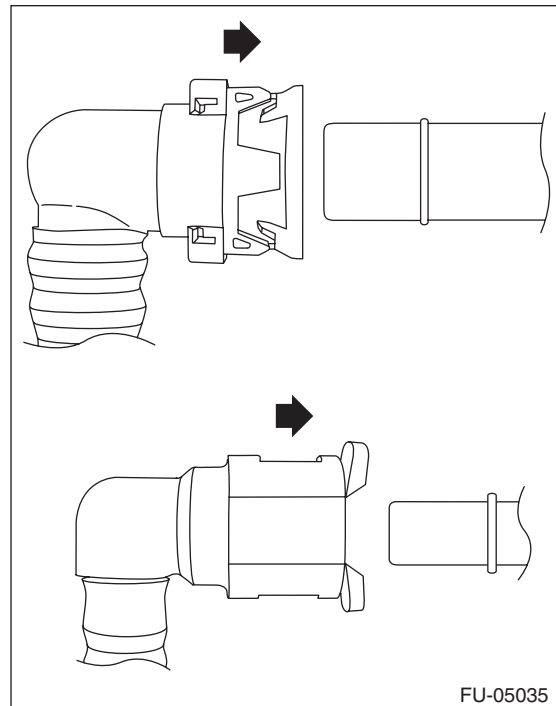

# Fuel Delivery, Return and Evaporation Lines

## FUEL INJECTION (FUEL SYSTEMS)

### 2. CONNECTING THE FUEL LINE QUICK CONNECTOR

#### CAUTION:

- Make sure there are no damage or dust on connections. If necessary, clean seal surface of pipe.

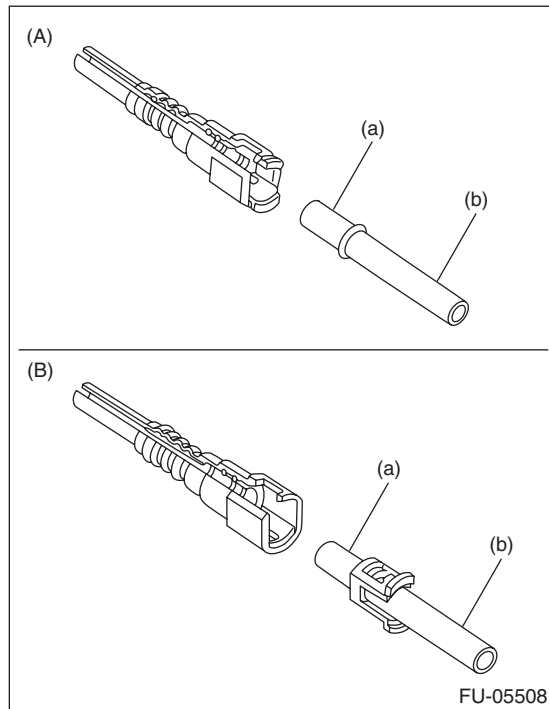

- (A) When removed using the ST  
(B) When removed without using the ST  
(a) Seal surface  
(b) Pipe

- When reusing the retainer, make sure that neither scratches nor deformation exist on the retainer. If it is faulty, use a new part.

1) Connect the quick connector to pipe.

#### CAUTION:

- Make sure that the quick connector is securely connected.

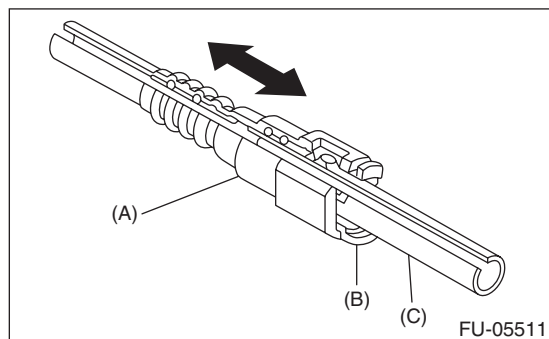

- (A) Quick connector  
(B) Retainer  
(C) Pipe

- Make sure the two retainer pawls are engaged in their mating positions in the quick connector.
- Be sure to inspect tubes and their connections for any leakage of fuel.
- To connect the connector, hold (d) shown in the figure and push in axial direction.
- When connecting the connector, do not bend or twist the tube forcibly. If the tube is bent, replace with a new part.

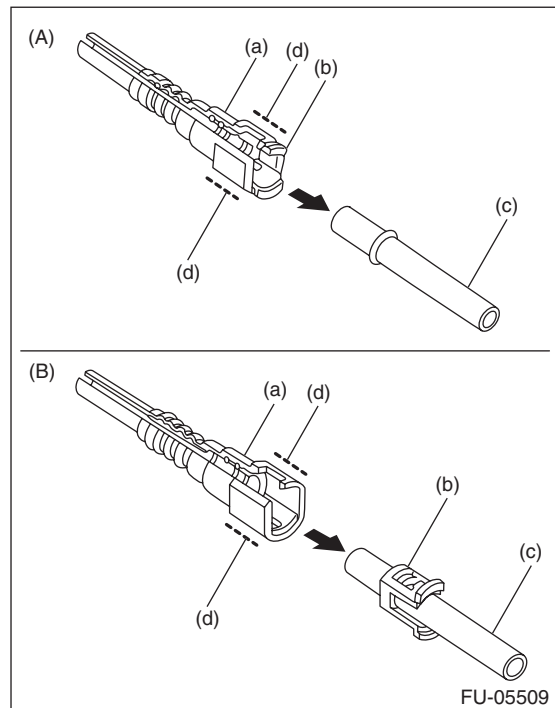

- (A) When removed using the ST  
(B) When removed without using the ST  
(a) Quick connector  
(b) Retainer  
(c) Pipe  
(d) Connector holding position

## 3. CONNECTING FUEL DELIVERY HOSE, FUEL RETURN HOSE AND FUEL HOSE

Connect the fuel delivery hose, fuel return hose, and fuel hose as shown in the figure.

### CAUTION:

- If the connection portion has a spool or stopper, do not allow the end of the hose to bend or ride over by inserting the hose too deep.
- Be sure to inspect hoses and their connections for any leakage of fuel.

### NOTE:

Use new fuel delivery hose, fuel return hose, and fuel hose.

### Tightening torque:

**1.25 N·m (0.1 kgf-m, 0.9 ft-lb)**

**L1:  $2.5 \pm 1.5$  mm (0.098  $\pm$  0.059 in)**

**L2:  $22.5 \pm 2.5$  mm (0.886  $\pm$  0.098 in)**

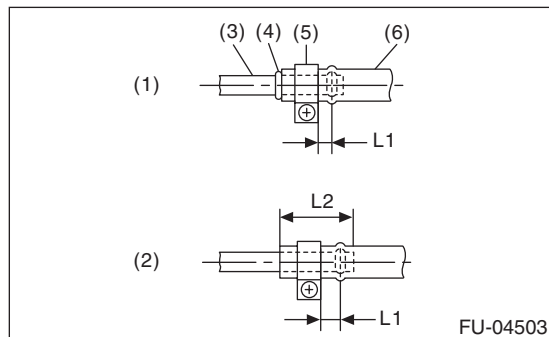

- (1) When there is a spool or bump
- (2) When there is no spool or bump
- (3) Pipe
- (4) Spool or bump
- (5) Clamp
- (6) Hose

## 4. EVAPORATION HOSE CONNECTION

Connect the evaporation hose to the pipe with an overlap of 15 to 20 mm (0.59 to 0.79 in).

**$L = 17.5 \pm 2.5$  mm (0.689  $\pm$  0.098 in)**

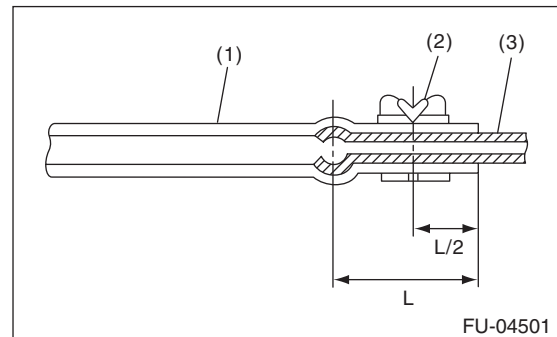

- (1) Hose
- (2) Clip
- (3) Pipe

## 5. BODY INTEGRATED UNIT INSTALLATION

Tighten the bolts and nuts in the figure to the torque specified below.

### Tightening torque:

**7.5 N·m (0.8 kgf-m, 5.5 ft-lb)**

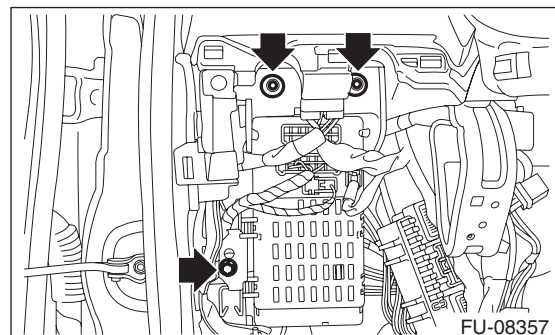
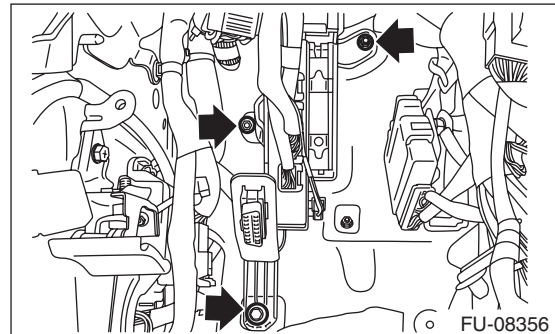

## C: INSPECTION

- 1) Check that the fuel pipe has no deformation, cracks or other damages.
- 2) Check that the hose and tube have no cracks, damage or loose part.